

# MIG ENERGY SAVING PAINT

[www.mig-mbh.de](http://www.mig-mbh.de)

**Experience Colours**

**Save Energy**

**MIG Products**

MIG  
Energiesparfarbe, weiss



**The Right Paint! A valuable part of your energy saving house!**



# THE RIGHT PAINT FOR YOUR MICROCLIMATE

Unique colour experience through a personal **MICROCLIMATE** in your home.

Feeling comfortable within your own four walls does not have to start with the furniture. Choosing **MIG-ESP** is important in creating a comfortable atmosphere in a room. Hence the quality and colour shades of the paint play a special role. Additionally, energy conservation should not be limited to the reduced consumption of cooling / heating energy, because energy costs will always continue to rise. Therefore, it pays off to use our paint for new builds and renovations.

## How does microclimate work?

Indoor climate is determined by four factors:

- Air temperature
- Relative air humidity
- Temperature of the surrounding surfaces of the room (heat radiated from ceiling and walls)
- Air movement (drafts and dust build-up)

How can a high level of comfort be achieved?

The right mix of ventilation, heating and insulation is essential. Proper ventilation not only helps remove harmful substances, such as dust and odours, from your house, but also reduces humidity, which affects room temperature and mould growth significantly.

Surface temperature of the wall has a large effect on room temperature. Non-insulated walls emit cold air and cool down the room faster. When a room is too cold, condensation will occur on interior walls due to air humidity, and the walls will become damp, providing an ideal environment for mould formation. Furthermore, large differences between room and wall temperature lead to strong airflow, promoting draft, cooler at floor level and dust movement. So the interior surfaces must be constantly heated, which results in an unnecessary increase in heating costs.

A good insulating system is therefore necessary. Apart from minimizing heat loss in winter and lowering energy costs, it prevents the build-up of heat inside the home in summer, ensuring a pleasant microclimate all year round.

**MIG-Energy Saving Paint** interior paint does not only fulfill the basic function of coating the walls, but also takes on the important role of insulation. It minimizes air movement, humidity and determines temperature conditions in a room.

## Energy Saving Paint for Interior Walls

**MIG-Energy Saving Paint** meets the highest ecological requirements. Its breathable materials contribute to an excellent room climate and optimizing an optimal indoor humidity and pleasant temperature. Consequently, it helps reduce energy use in a sustainable way.



- Energy conservation of up to 40%
  - Optimal surface temperature
  - Optimal SD and W Value
  - High breathability
- Considerably better indoor climate
  - Controls Moisture
  - More uniform distribution of wall temperature (minor dust buildup and not cooler at floor level)
  - beneficial for allergy sufferers
  - Excellent protection against mould formation
  - Solvent free
- Other features:
  - Smooth surfaces
  - Less dust build up
  - Crack repair up to 0.5mm
  - Sound-absorbing



**The indoor air is pleasantly fresh in summer, and the room remains comfortably warm in winter.**

# HYGROTHERMAL EVALUATION WITH WUFI® PRO

A program by the Fraunhofer Institute for Construction Physics IBP

## Impact of a coating on a exterior west facing wall

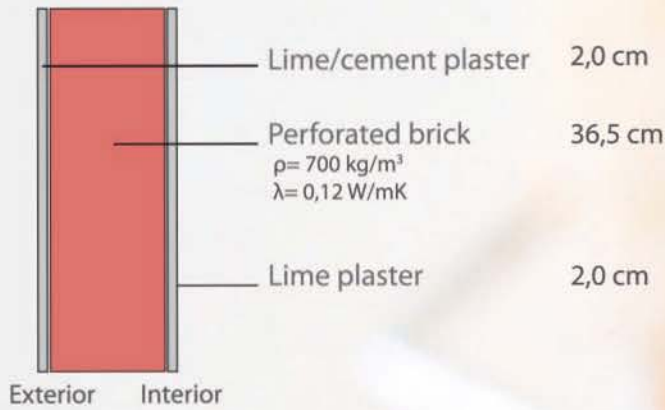

### Heat Input

MIG Energy Saving Paint

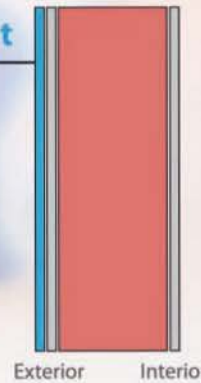

Reduction of 35%

$S_d$ (m)	W (kg/m <sup>2</sup> /h)
0,05	0,05

Heat Quantity from  
22,1 to 14,4 kWh/m<sup>2</sup>a

### Heat Loss

MIG Energy Saving Paint

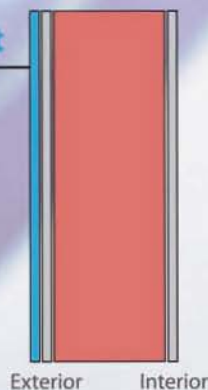

Reduction of 42,3%

$S_d$ (m)	W (kg/m <sup>2</sup> /h)
0,05	0,05

Heat Loss from  
-79,6 to -45,9 kWh/m<sup>2</sup>a



# THE RIGHT PROTECTION FOR EXTERIOR WALLS

Longer periods between repainting and better protection for your walls!

## Exterior Paint – Protection and improves the appearance of your house

An exterior paint should function as a form of protection and improve the appearance of your house. Therefore, it is important to choose an exterior paint that fulfils both requirements. In addition, energy efficiency should be taken into account when choosing exterior paint.

### The Right Paint for Your Facade

Like a polish makes your car look nicer and newer, the right paint for your house can make it shine. The right combination of colour for the roof, walls, windows and doors are important details to enhance the appearance of your house.

However, beautifying your home is only one part of the job this **MIG-ESP** provides. It also provides the right protection for your home against algae and dirt, which helps maintain its well kept appearance.

When choosing an exterior paint, quality plays an important role as well as the desired colour shades.

### Protection for your Facade

An exterior paint is like a shield for your house, which must fulfil many functions. It must be weatherproof against frost, rain, sun and air pollution; it must ward off moulds, fungi and mosses. This paint shields the whole building structure from cracks and moisture, on top of a good insulating system. A functional barrier against humidity means a significant reduction in heat loss. Normally, an increase of 1% in humidity levels can cause an over 10% loss of heat. **MIG-ESP** supports thermal insulation and provides protection against unnecessary heat and energy loss. This will substantially lower your heating and cooling cost, hence meeting the legislator's energy efficiency requirements (if applicable in your area).



## Energy Saving Paint for Exterior Walls:

**MIG-Energy Saving Paint** protects your home in all weather conditions:

from environmental pollution, UV-rays and other factors. Its breathable material prevents brittleness, thanks to its highly elastic surfaces and, consequently, keeps crack formation at bay. This will prevent moisture from penetrating the wall and eliminate breeding grounds for moulds, fungi, algae and mosses, without the presence of chemical additives in our paint. Due to its special surfaces structure and highly breath-able material, **MIG-ESP** allows humidity to evaporate and increases the overall insulating performance. As a result, the walls cool down at a significantly slower pace. Less heat energy will be consumed, because existing heat will be retained longer in the walls.



Smooth and crack filling surfaces

- Saves Energy
- Controls Moisture
- Excellent protection against algae and fungal infestation
- CO<sup>2</sup> reduction: due to its highly reflective surfaces
- Less dirt build-up
- Crack repair up to 0.5mm
- Optimal surface temperature
- Lower surface tension
- Prevention against condensation
- Optimal SD and W values

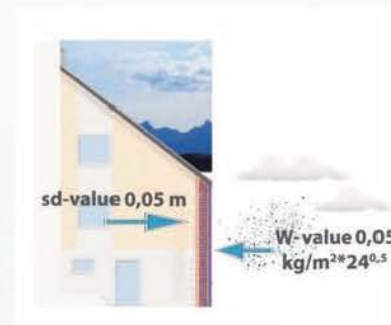
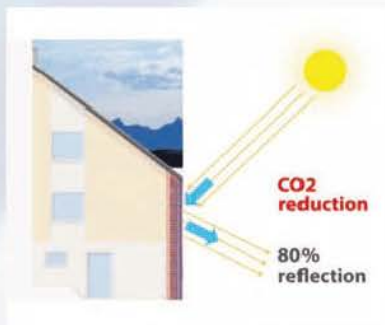

# AN INDISPENSABLE PUZZLE PIECE FOR YOUR ENERGY EFFICIENT HOME!

Measurements by Professor Marx of the Beuth University of Applied Science in Berlin, Germany

■ Chamber with MIG-Energie Saving Paint  
■ Chamber with normal paint

Temperature change in two structurally identical test chambers  
After 14 hours of night cooling with an initial temperature of 22°C

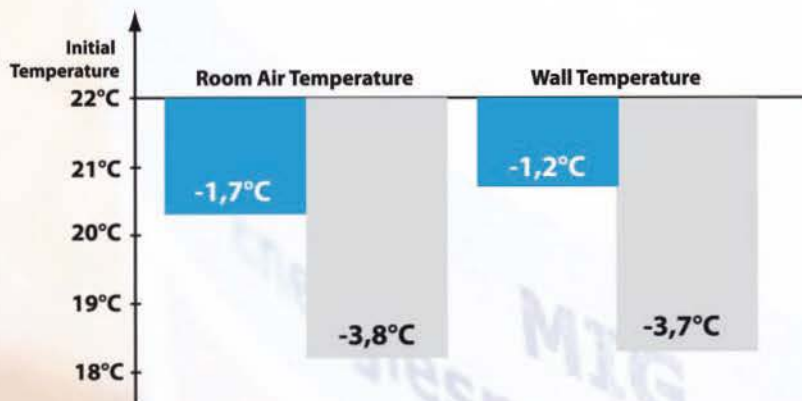

## Cooling of Test Chambers

Positive temperature change in two structurally identical test chambers  
After 40 minutes of heating with a 2 kW fan heater with closed windows

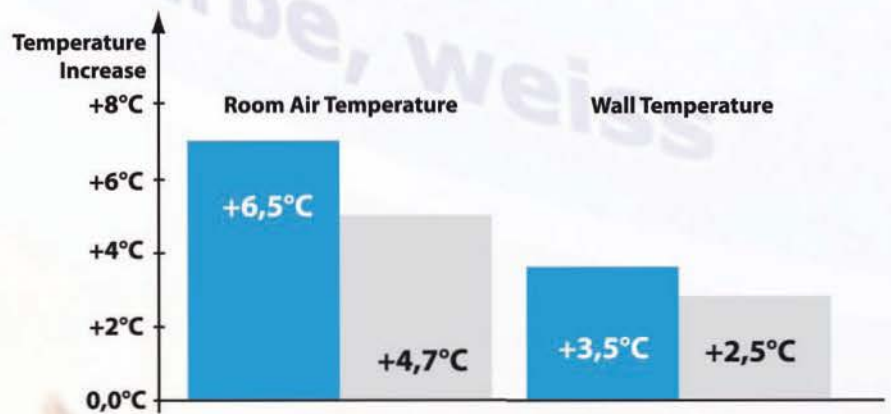

## Heating of Test Chambers

40%  
 ↓  
Up to 40% less heating energy  
100% essential heating energy for a comfortable room temperature

## Energy Consumption

After 14 hours of night cooling, heating energy needed to return the two structurally identical test chambers to the same level of thermal comfort.



# OUR COLOUR-SERVICE

We have the right colour for any surface!

In our colour palette, you will find the right colour for your surface of stone, plaster, plate, steel or wallpaper. Please visit our website for a list of colour options. For all other colour requests please feel free to contact us and we will match them to your satisfaction. For highly absorbent substrate please use our penetrating primer: [MIG-E-Primer](#).



## More than just colour

Different colours have different effects on the room. When used strategically, you can structure, revive, downsize, enlarge, warm up or cool down your living space.

Ask our trained local partners, they will help you to find the right color for your needs.

### Your local partner



Packaging  
5 litre and 15 litre

Usage  
1 l per 3,5 - 5 m<sup>2</sup>  
(depending on surface)  
2 coats recommended



## MIGmbH

Am Grarock 3  
33154 Salzkotten  
Germany

Fon: +49(0)52 58-9 74 82-0

Fax: +49(0)52 58-9 74 82-29

[info@mig-mbh.de](mailto:info@mig-mbh.de)

[www.mig-mbh.de](http://www.mig-mbh.de)



material innovative  
gesellschaft mbh